

The drum elevator is made of welded steel with a protective coating; the frame is completely detachable to reduce dimensions during transport.

The drum elevator includes only the main frame with a mechanical disk braking system and should be completed with the optional CDR 002 or CDT for CVI 600 and CDR 057 or CDT for CVI 810. The picture shows the CVI with the CDR and the TIH

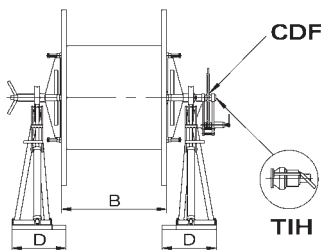

Certified Quality System
ISO 9001:2000

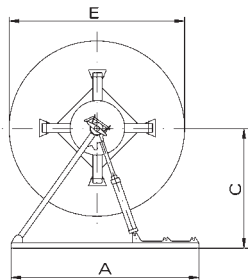

CVI + CDR

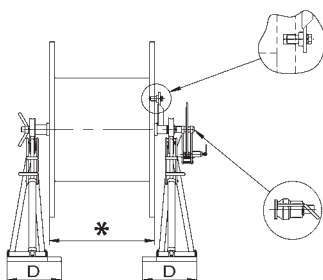

CVI + CDT (*)

| Model | Dimensions [mm] | | | | | | | | Capacity [kN] | Mass [kg] |
|---------|-----------------|------|------|------|------|-----|------|------|---------------|-----------|
| | A | Bmin | Bmax | Cmin | Cmax | D | Emin | Emax | | |
| CVI 600 | 2140 | 500 | 1500 | 580 | 1340 | 640 | 1200 | 2500 | 70 | 430 |
| CVI 810 | 2500 | 800 | 1850 | 720 | 1725 | 740 | 1500 | 3200 | 100 | 550 |

CONFIGURATION

One manual disk brake CDF 012 (Max torque 1 kN x m) for CVI 600
One manual disk brake CDF 059 (Max Torque 2.3 kN x m) for CVI 810

EQUIPMENT ON DEMAND for CVI 600

- CDR 001 Support with fixing wedges for wooden conductor drums
- CDR 002 Support with self-locking fixing wedges for wooden conductor drums
- CDT XXX Special driver with fixed wedges for steel conductor reels (reel drawing is required) (*)

EQUIPMENT ON DEMAND for CVI 810

- CDR 057 Support with self-locking fixing wedges for wooden conductor drums
- CDT XXX Special driver with fixed wedges for steel conductor reels (reel drawing is required) (*)

Kit of connecting hoses

- TUT 001 length 7 m, mass 11 kg
- TUT 002 length 10 m, mass 15 kg
- TUT 003 length 15 m, mass 23 kg

OPTIONAL for CVI 600

- CDA 004 Adapter for steel rope standard reel
- CDD 005 Automatic level wind for standard steel rope reels (B = 560 mm)
- CDF 013 Manual disk brake (Max torque 2.3 kN x m)
- TIH Fast assembling hydraulic motor for control of the drum winding and unwinding

| Model | Max Torque [kNxm] | Max rotating speed [RPM] | Mass [kg] |
|---------|-------------------|--------------------------|-----------|
| TIH 001 | 1,8 | 45 | 76 |
| TIH 006 | 2,3 | 32 | 78 |

OPTIONAL for CVI 810

- CDA 060 Adapter for steel rope standard reel
- TIH 007 Fast assembling hydraulic motor for control of the drum winding and unwinding

| Max Torque [kNxm] | Max rotating speed [RPM] | Mass [kg] |
|-------------------|--------------------------|-----------|
| 2,3 | 32 | 78 |



Mod. TIH